

The Power of Three.

Each element of the King's Trilogy cannot exist in isolation – they work in unison to produce something very special. The Mind, Body and Soul campaign is an enthusiastic and strategic response to the need to provide the very best facilities – both structural and spiritual – to enlighten the eager young minds of today, produce the leaders of tomorrow and leave a legacy that will continue to inspire students for generations to come.

The social and physical growth of a person is as important as their academic development. King's encourages students to develop a healthy lifestyle to gain full enjoyment from their physical activities and to use their leisure time productively.



This holistic approach prepares students for a competitive world, whilst fostering co-operation and integrity. Whether in the music room or on the playing field, physically engaging with the task ensures learning, understanding and satisfaction.

This collegial spirit exhibited in all activities at King's encourages an appreciation of achievements, not just in the individual but also within the greater school community.

Body



Soul

Hundreds of students have found their inner voice through the Voyager Programme in which they are encouraged to explore their spiritual beliefs in a safe environment.

The vast majority of King's students voluntarily participate in the many Community Service programmes. The values they learn are reinforced and made real, giving them the ability to use these principles to the benefit of the world around them.

From the Headmaster

Mind, Body and Soul is the start of a new era at King's College. It embodies the strategic planning process of the College and illustrates its future direction.



Mind, Body and Soul represents our vision to provide excellence in teaching and learning within a broad educational context involving the academic, cultural, social, physical, emotional and spiritual dimensions of life.

This on-going strategic plan will incorporate, in phase one, the fundraising programme for two exciting new buildings; the Design Technology Centre and the Chapel Close. With the Campaign Chairman, Jim McLay, guiding us through this ambitious process I have no doubt that Mind, Body and Soul will be a successful and hugely beneficial campaign for current and future King's College students and will help us to remain at the forefront of education in New Zealand and beyond.

Roy Kelley

From the Campaign Chairman

As the College enters this new and exciting era, these new facilities will benefit current students and those in generations to come.



The plans outlined here for the new Design Technology Centre and the Chapel Close will contribute handsomely to our goal of always "providing the best all-round education it is possible to obtain". This has been self-evident since the College was founded and remains just as relevant in today's fast-changing educational environment.

I commend these two projects to you as part of the continuing development of the College particularly for the positive impact they will have on both students and staff.

The school community has been very enthusiastic with their generous support for past projects and it is our hope that this generosity will continue.

Jim McLay



KING'S COLLEGE

Mind Body AND Soul

THE KING'S TRILOGY

Mind, Body and Soul. The King's Trilogy

The College's vision to "provide the best all-round education it is possible to obtain", has been in place since 1896. Throughout the years this abiding aim has evolved to embody the education of the whole person – academically, physically, culturally, socially, emotionally and spiritually.

The approach to teaching at King's encourages best practice and innovation, providing each student with the tools to fully explore all academic boundaries so they may realise their potential.

Traditional classroom-based teaching cannot provide the dynamism of a team and project-based environment. King's offers experiential learning that awakens curiosity, discovers individual talents and allows students a better opportunity to succeed.

King's College gives the minds of future leaders a far greater dimension... by celebrating diversity, promoting ethical policies, encouraging an appreciation for arts and culture, and engendering respect.



Mind

"Students learn to value the diversity of the learning experience and hence, the world."
Dr John Hood – Vice Chancellor, Oxford University



"The Chapel is at the heart of King's College and always will be... and the chaplaincy operates the most effective programme of any school in the country."
The Right Reverend John Paterson, Bishop of Auckland.

The answers to the big questions in life are not usually found in a text book. The pathway to emotional and spiritual satisfaction does not come with a signpost. The College provides an effective and modern pastoral care system which assists students in the pursuit of faith, whilst actively putting Christian ethics into practice.





T H E P R O J E C T S

The importance of Design Technology is its ability to **offer experiential learning and encourage practical classroom environments for all students.**

King's College is blessed with a Chapel of breathtaking magnificence. **The Chapel Close will add another relevant dimension to how the chaplaincy now works for students.**



The Design Technology Centre

a state-of-the-art, practical and problem solving environment.

Design is deceptive. It looks so simple and obvious. Creating new products is a careful blend of innovative thinking, quality technology and fine design.

Great ideas evolve when inspired individuals have 'the right moment' in the right environment. This can then translate into the manufacture or creation of something that anticipates and solves a problem.

The new Design Technology Centre will provide such an environment with an array of design suites, open-plan learning environments, workshops and technology hubs.

Students will work in a programme based on the principles of design, manufacture and appraisal. For a future career in farming, apprenticeships, engineering, architecture or the sciences, students will experience a range of contemporary technologies significant to the international marketplace.

The main Design Technology learning area will be a large open space that caters for a diverse range of activities. A suite of computers will be available to use for 3D design, digital imaging, and virtual testing. The computers will be directly linked to manufacturing machines allowing precision construction of components.



Tools and machinery dedicated to working with a variety of materials will reside in this space allowing a seamless flow between design and manufacture.

The building has built-in flexibility for storage and safety, with clear staff sight-lines for supervision, and continuous air-flow mechanisms and extraction features, ensuring clean air at all times. The impact of noise will be reduced with acoustic isolation materials and external motors for fans.

The Centre will also house the new facilities for Art and Graphics Departments.

These departments will embrace a suite of multi-function rooms catering for studio and design space, a senior painting and sculpture workspace and an Artist-in-Residence studio, which will double as a photographic studio. This entire area will be enabled for wireless internet, with a range of data projection devices. The space will be fitted with sound-proof partitions that will allow the room to be re-configured for large or small teaching situations. A resource room will provide vital access to research material such as magazines, books and printing equipment.

Graphics will be divided into three spaces with two classrooms and a model-making room. The layout of the area allows for teaching of both traditional drawing board methods and CAD. Technology, including data projectors, DVDs and sound equipment, will enhance the teaching capabilities. The model-making room, which will be shared with Art, will allow 3D model-making using a range of materials and equipment. The activities will range from delicate airbrushing to bandsawing.

Students will have the opportunity to benefit from their learning in this Centre... for all vocations, including new age mechanical or computer engineering, mechatronics or robotics.



The Design Technology Centre won't be just about making things. It will be about learning how to learn, learning how to work with others and learning to conceive and conceptualise new and innovative solutions to problems.

The Chapel Close

more than a place of worship

The stunning King's College Memorial Chapel has long been at the heart of the school, not just for what it is, but what it does. Its influence on students' lives goes beyond the building, and the position of chaplain has progressed beyond the instruction of religious studies. We need to have a building which is able to reflect the importance of a contemporary values-based education.

The role of the chaplaincy embraces being counsellor, teacher, advisor, friend, and mentor, as well as providing pastoral care.

The value of the Chapel Close will be its ability to engage students in this growing range of activities; to bring relevance and a new perspective to the Christian character of King's.



Two programmes have been initiated over recent years to bring a new relevance and meaning to the spirituality of the College. Both the Community Service and Voyager Programmes have been fully embraced by students, with over half the school participating in community outreach. Nearly three hundred students explore their Christian faith and have taken their own spiritual journey through Voyager.

As the role of the chaplaincy grows, so does the need for facilities to support the increasing demands put on it. For effective spiritual sharing and exploration, it is important to offer a space which is more private and personal in nature than that of a normal classroom.

The Chapel Close will comprise rooms to accommodate the Voyager Programme, choir and religious studies, a small private Chapel, offices and storage facilities.

The Chapel is an extremely busy place and it has become increasingly difficult for students to use that space for private reflection. A new, smaller prayer space, with a seating capacity of approximately 25, is planned and will be ideal for that purpose and smaller services when required.

The chaplains' existing office area will be upgraded and new offices built for the assistant chaplain and the community service coordinator.

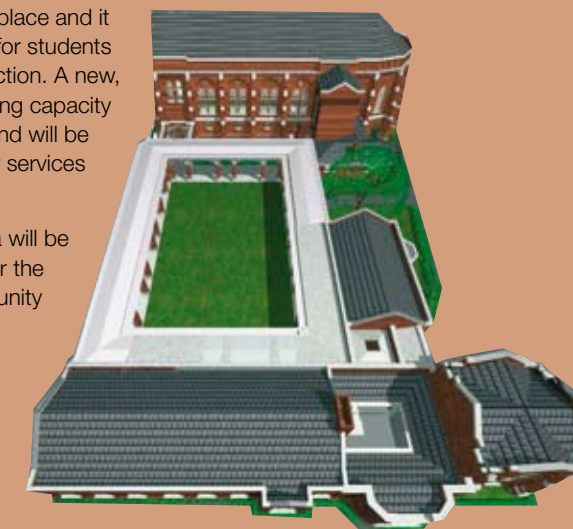

New cloisters will enhance the magnificent Memorial Chapel. It will be a tranquil and beautiful area, reflecting and celebrating the burgeoning spirit of community fostered within the walls of the adjoining buildings.

